

1st Floor

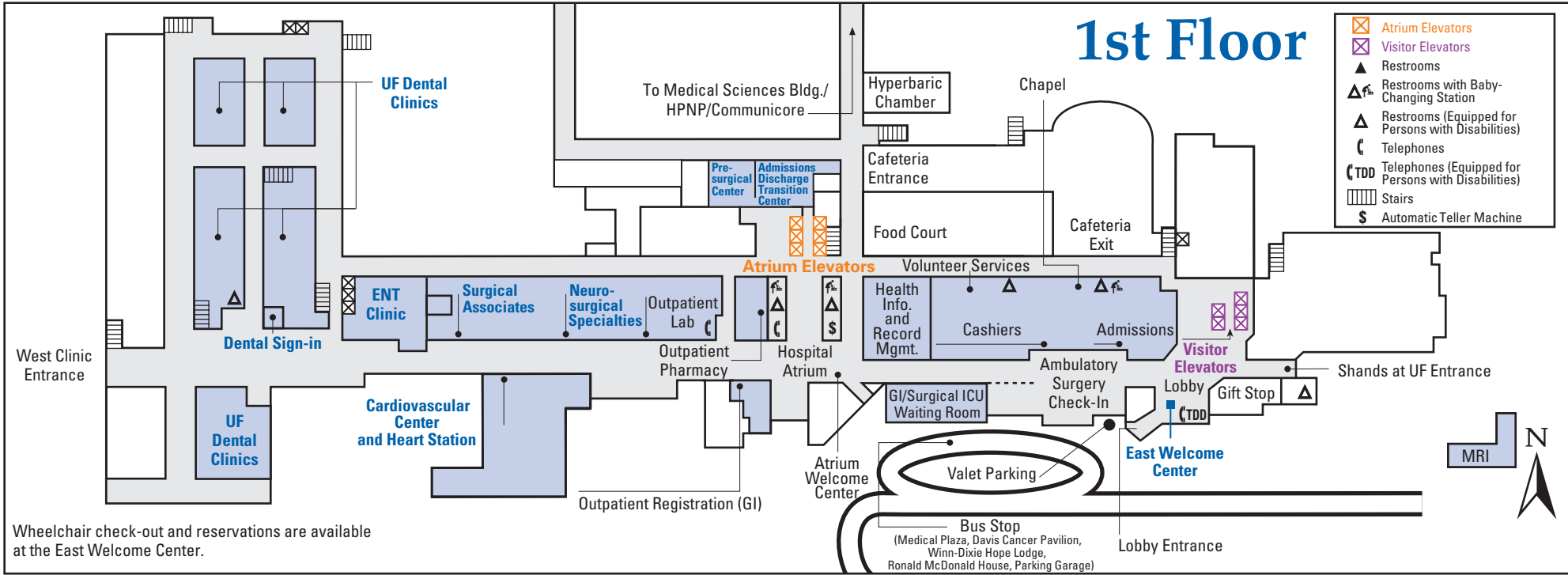

Wheelchair check-out and reservations are available at the East Welcome Center.

Finding Your Way at Shands at UF

Thank you for choosing Shands at UF and Shands Children's Hospital at UF as your healthcare centers. We hope you find these interior maps helpful in finding your way.

Please note: Outpatient practices are designated by bold, blue type.

Information

If you have questions, call one of the numbers below:

- Main number – 352.265.0111
- For information about appointments, call 352.265.0943 or 866.931.1185
- East Welcome Center (main entrance of the hospital, near east end of complex), 352.265.0111, x 45758

If you need special help upon arrival at Shands at UF because of a disability, phone the East Welcome Center at 352.265.0111, x 45758.

Note: The *Atrium Elevators* do not go to the 8th, 9th, and 11th Floors. Please use the *Visitor Elevators*.

2nd Floor

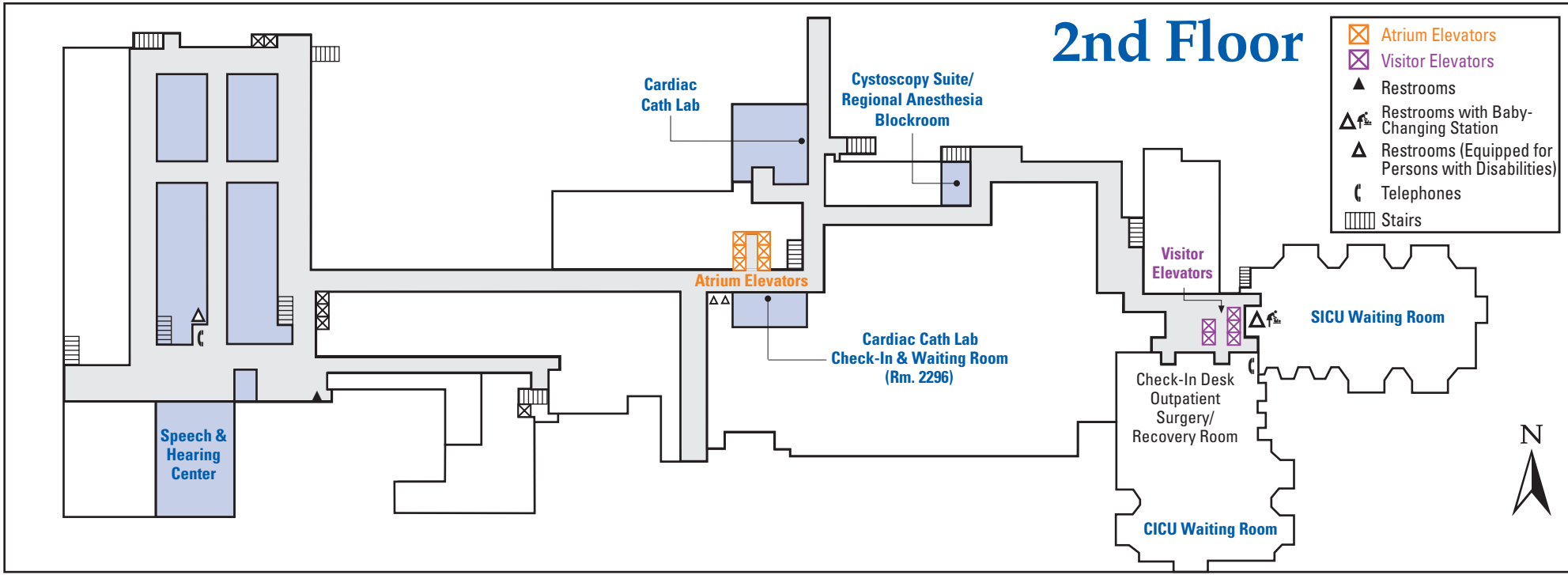

About Shands at UF

Founded in 1958, Shands at UF is a not-for-profit hospital that serves as one of the Southeast's leading treatment and referral centers. It offers areas of excellence in cancer, cardiovascular, neurosurgery and transplant services, as well as pediatric services at Shands Children's Hospital at UF.

Shands at UF is recognized as one of the top hospitals in the United States, and UF physicians are consistently ranked among the country's best.



5th Floor

- Atrium Elevators
- Restrooms
- Restrooms (Equipped for Persons with Disabilities)
- Stairs

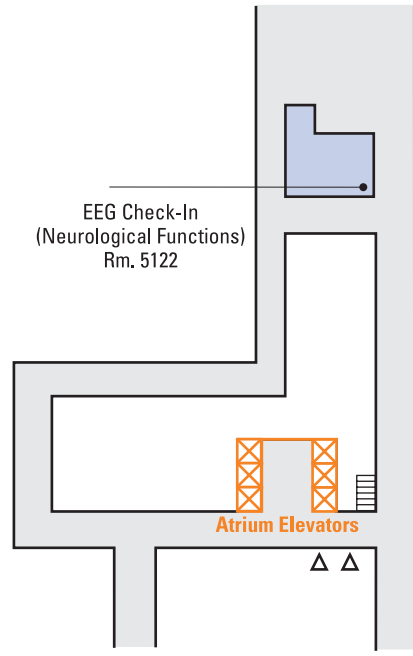

6th Floor

- Atrium Elevators
- Visitor Elevators
- Restrooms
- Restrooms (Equipped for Persons with Disabilities)
- Stairs

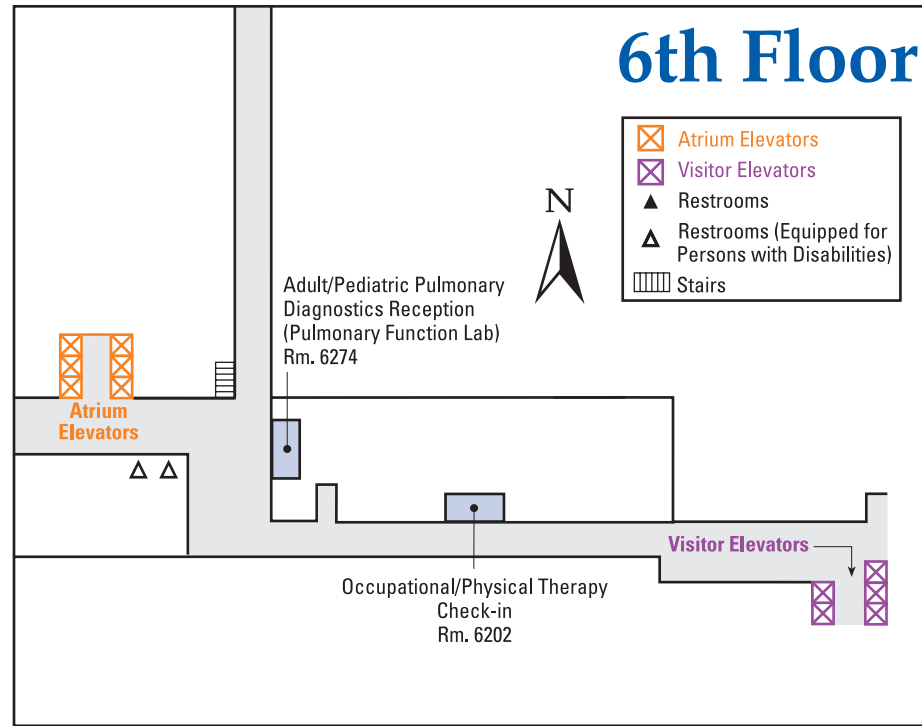

7th Floor

- Atrium Elevators
- Visitor Elevators
- Restrooms
- Restrooms (Equipped for Persons with Disabilities)
- Stairs

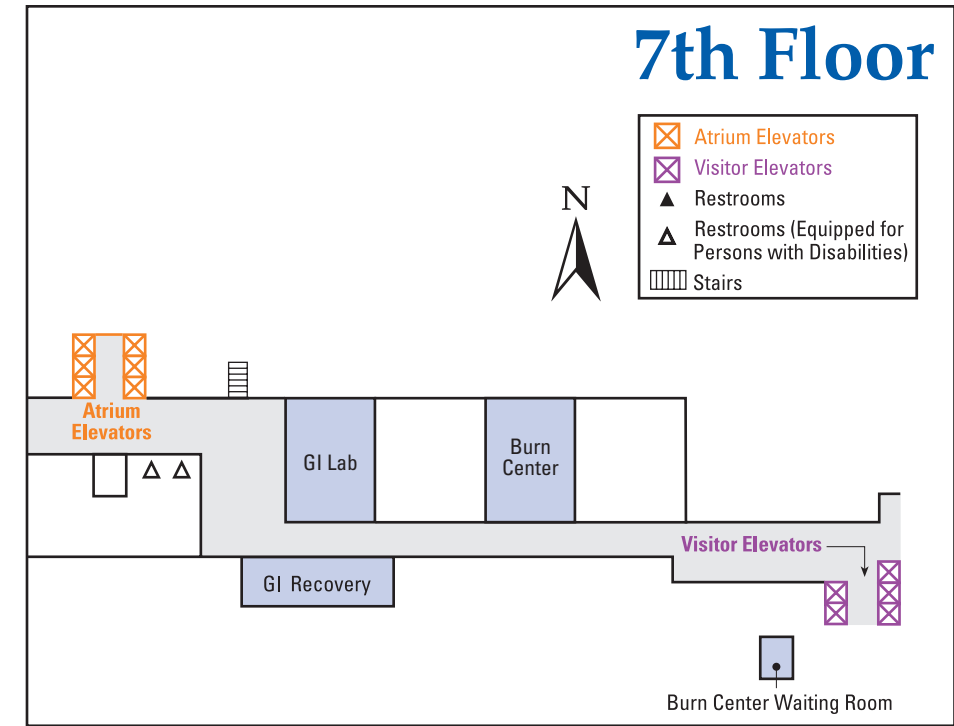

Note: The Atrium Elevators do not go to the 8th, 9th, and 11th Floors. Please use the Visitor Elevators.

SHANDS.ORG

Ground Floor

- Atrium Elevators
- Visitor Elevators
- Restrooms
- Restrooms (Equipped for Persons with Disabilities)
- Restrooms with Baby-Changing Station
- Telephones
- Stairs
- Automatic Teller Machine

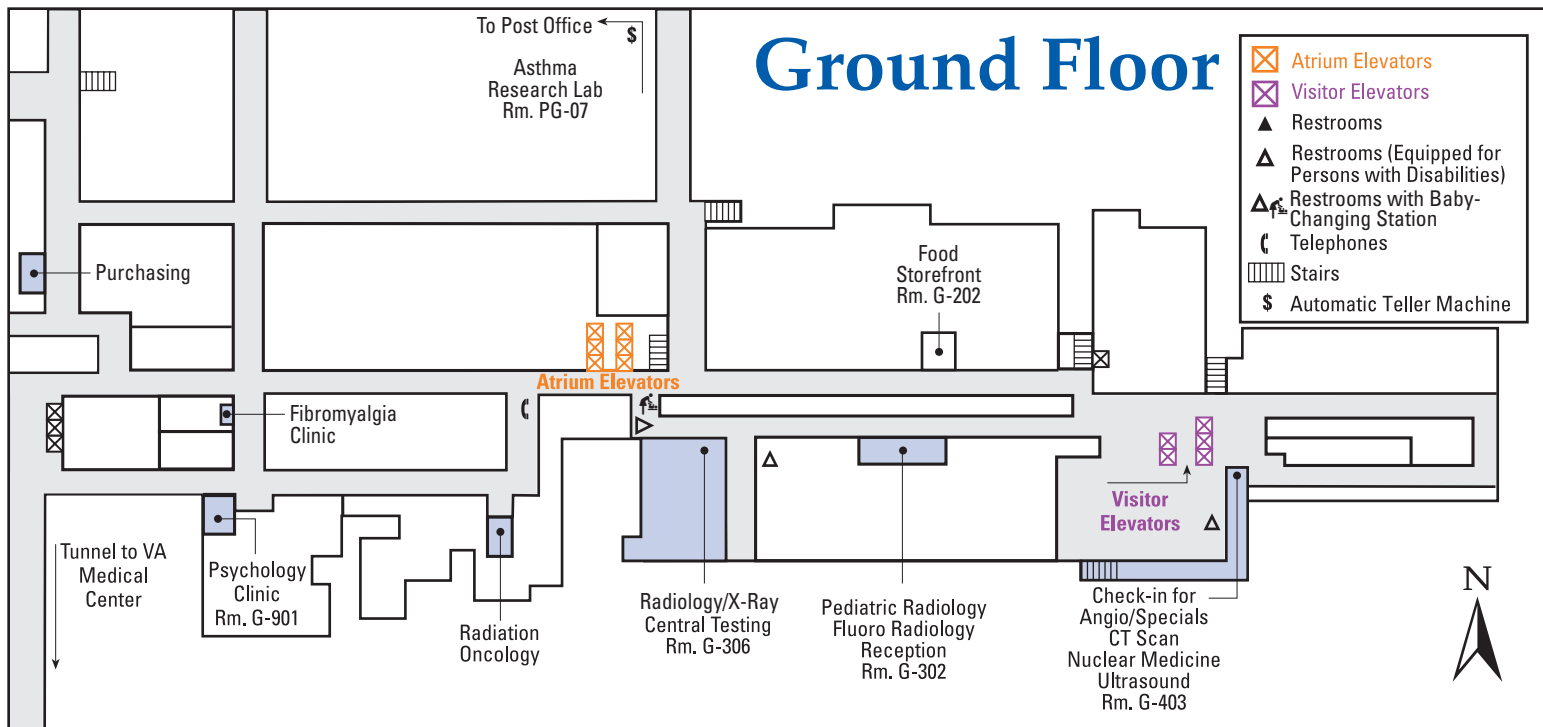

Parking Locations

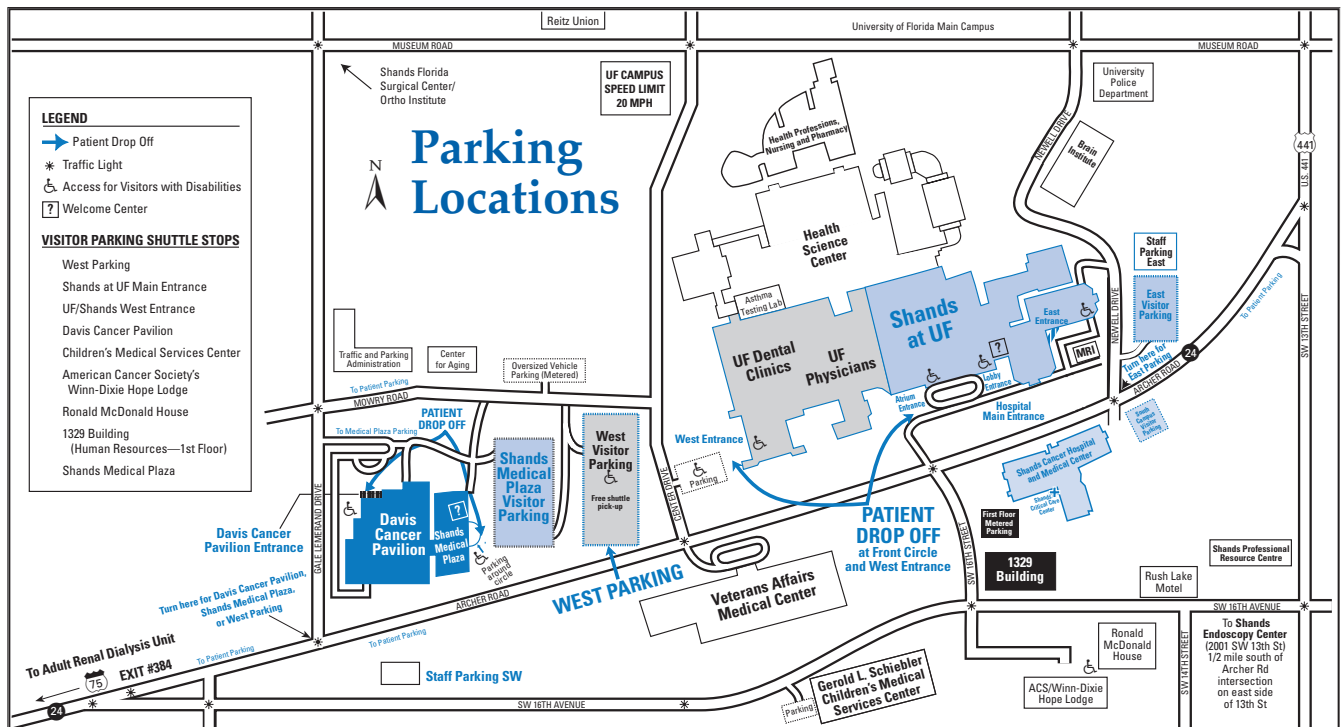

- LEGEND**
- Patient Drop Off
 - Traffic Light
 - Access for Visitors with Disabilities
 - Welcome Center
- VISITOR PARKING SHUTTLE STOPS**
- West Parking
 - Shands at UF Main Entrance
 - UF/Shands West Entrance
 - Davis Cancer Pavilion
 - Children's Medical Services Center
 - American Cancer Society's Winn-Dixie Hope Lodge
 - Ronald McDonald House
 - 1329 Building (Human Resources—1st Floor)
 - Shands Medical Plaza